

INSTALLATION INSTRUCTIONS

- 1- REMOVE GRILL
- 2- INSTALL THE HANDLE ON THE BACK OF THE UPPER PANEL AS ILLUSTRATED.
- 3- PLACE THE UPPER PANEL OF BUG AND GRILL DEFLECTOR, MAKING SURE IT IS CENTERED ON THE HOOD.
- 4- MARK THE HANDLE HOLES ONTO THE HOOD.

CAUTION

REMOVE THE HOOD DEFLECTOR TO PREVENT DAMAGE

- 5- DRILL THE HANDLE HOLES MARKED AT 9/32" (.28125) DIA.
- 6- INSTALL THE UPPER PANEL OF THE BUG AND GRILL DEFLECTOR AND FASTEN THE HANDLE TO THE HOOD AS ILLUSTRATED.
- 7- FASTEN THE UPPER AND SIDE PANELS TOGETHER.

NOTE 7.

- 8- FASTEN THE LOWER PANEL AND THE SIDE PANELS.

NOTE 8.

- 9- PLACE AND SCREW THE LOWER AND SIDE PANELS IN PLACE.
- 10- PLACE AND SCREW THE SIDE PANELS IN PLACE.
- 11- REINSTALL GRILL.
- 12- TIGHTEN ALL BOLTS AND SCREWS FIRMLY.

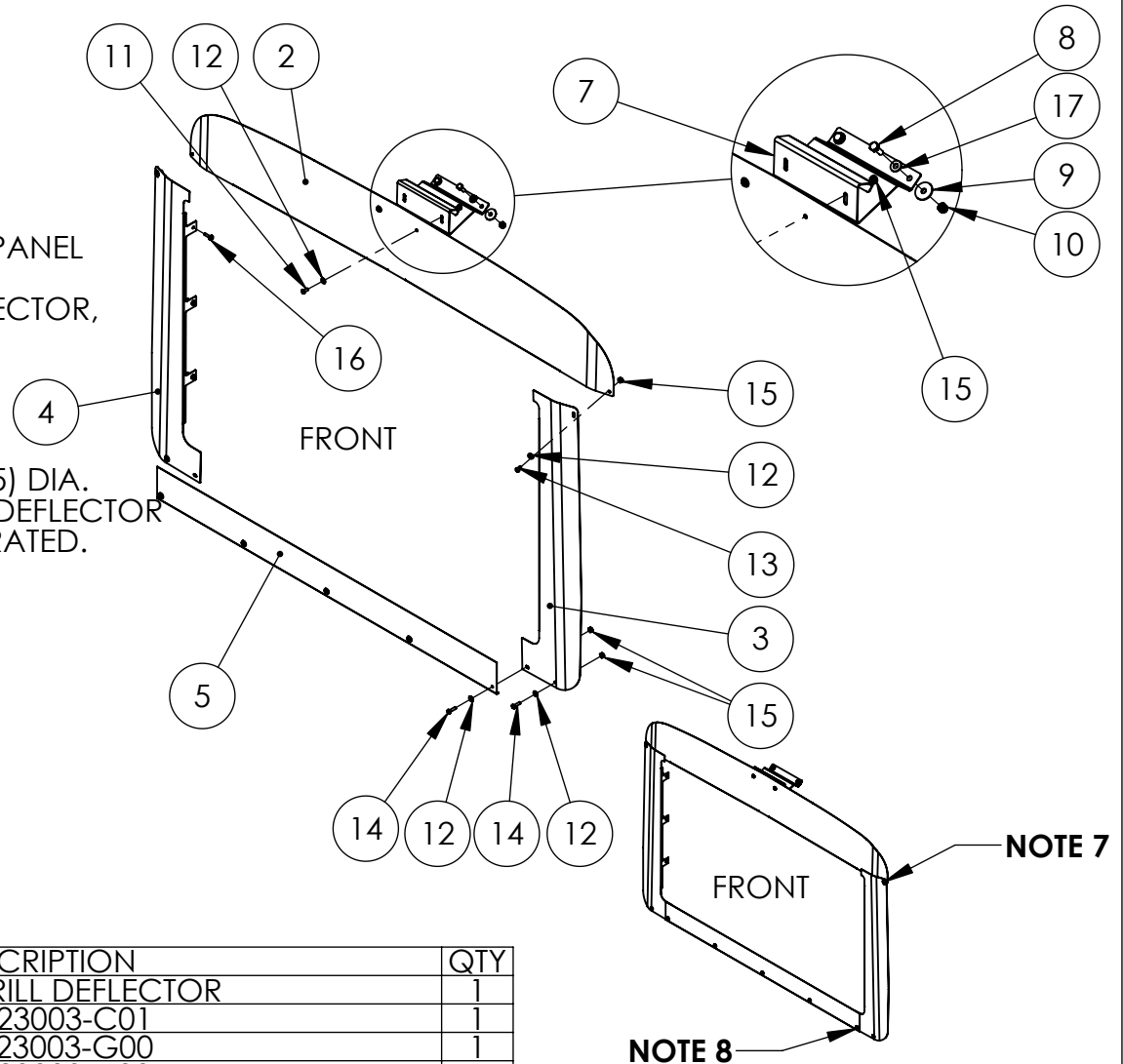

ITEM NO.	PART NUMBER	DESCRIPTION	QTY
1	M7723003SC	BUG & GRILL DEFLECTOR	1
2	-	PR7723003-C01	1
3	-	PR7723003-G00	1
4	-	PR7723003-D00	1
5	-	PR7723003-C02	1
6	K7723003BH	HARDWARE KIT INCLUDE:	1
7	-	PR7723003-C03	1
8	-	SS-HEX BOLT 1/4-20 X 3/4"LG	2
9	-	FENDER WASHER 1/4"X1 1/4"SS	2
10	-	NYLON LOCK NUT 1/4" SS	2
11	-	TRUSS PHILIPS 10-32 X 3/8" SS	2
12	-	FLAT WASHER #10 SS	11
13	-	TRUSS PHILIPS 10-32 X 1/2" SS	2
14	-	TRUSS PHILIPS 10-32 X 3/4" SS	7
15	-	NYLON LOCK NUT 10-32 SS	11
16	-	HEX. WASHER BOLT #10 X 3/4	12
17	-	FLAT WASHER 1/4"	2

METCHRO PRODUCTS

TITLE:
BUG & GRILL DEFLECTOR
VOLVO VN 630, 670, 730 & 780, 2003 & UP

SIZE DWG. NO.
A 7723003

NAME	DATE	REV	DATE
DRAWN BY C. R.	31-05-2006	PH1	-

SCALE: 1:16 WEIGHT: LBS SHEET: 1 OF 1